



2002-2009 MERCEDES BENZ E-CLASS
WAGON (W211 CHASSIS)
w/o ADS (489 code) A-2576
REAR AIR SPRING REPLACEMENT

Congratulations on your selection to purchase an Arnott Air Suspension System. We at Arnott Air Suspension Systems are proud to offer a high quality product at the industry's most competitive pricing. Thank you for your confidence in us and our product.

Proper installation is essential to experience and appreciate the benefits of this system. Please take a moment to review these installation instructions before you begin to install this system on your vehicle.

It is equally important to be aware of all necessary safety measures while installing your new Air Ride System. This includes proper lifting and immobilizing of the vehicle and isolation of any stored energy to prevent personal injury or property damage.

“Engineered to Ride, Built to last”



VERY IMPORTANT!!

THESE AIR SPRINGS CONTAIN A SOLENOID VALVE. ONCE INFLATED; ONLY THE “MERCEDES DAS STAR” DIAGNOSTIC COMPUTER CAN DEFLATE THE AIR SPRINGS.



WARNING: *The air suspension system is under pressure (up to 10 bar, or 150 lbf/in) verify pressure has been relieved and disconnect power to the air ride system prior to dis-assembly. Do not allow dirt or grease to enter the system. Always wear standard protective hand, ear, and eye protection when servicing the air suspension system.*

Kit contains:

PARTS LIST			
P/N	QTY	DESCRIPTION	
21-6040	2	REAR AIR SPRING	
14-5156	2	TOP CAP	
29-4504	2	RETAINING CLIPS	
29-2886	8	¼ -20 X ½ BUTTON HEAD SCREWS	
29-4471	1	4MM VOSS FITTING	



General information:

- * Not to be stored below 5 °F (-15 °C) and above 122 °F (50 °C).*
- *Avoid damage to air lines and cables.*
- *Removal and installation is only to be performed by full qualified personnel.*
- *Use car manufacturer's diagnostic software. *CAUTION: Damage to the vehicle and shock assembly can be incurred if work is carried out in a manner other than specified in the instructions or in a different sequence.*



REAR SHOCK REMOVAL:

NOTE: REAR AIR SPRING REMOVAL/INSTALLATION IS FOR BOTH THE REAR RIGHT AND LEFT AIR SPRING.



The ignition must remain switched off during the shock removal and replacement.

- 1.0 SET STEERING TO STRAIGHT AHEAD.
- 2.0 REMOVE POSITIVE BATTERY TERMINAL BEFORE STARTING WORK



Use lifting platform (hoist) that is capable of raising the body separately from the wheels, lift body at the lifting points prescribed by the vehicle manufacturer.

Vehicle slippage can cause danger to life and limb.

- 3.0 RAISE VEHICLE.
- 4.0 REMOVE REAR TIRE(S). (FIGURE 10-1)

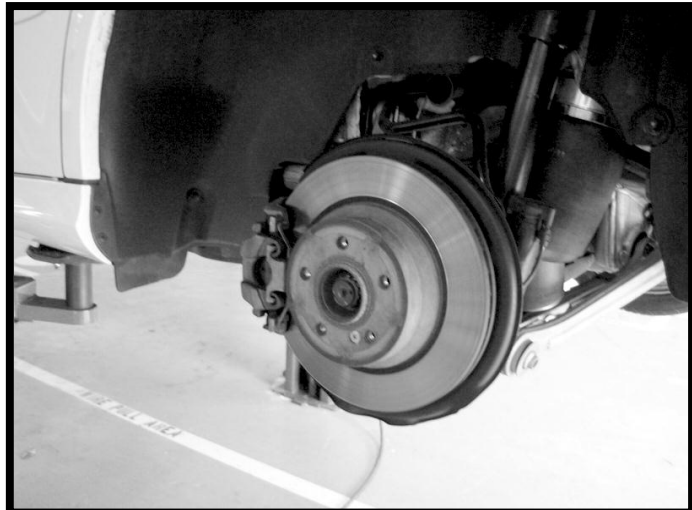

FIGURE 10-1



NOTE: *Air pressure! Release slowly and allow pressure to escape*

5.0 DISCONNECT AIR SPRING VALVE WIRING (Figure 10-2).

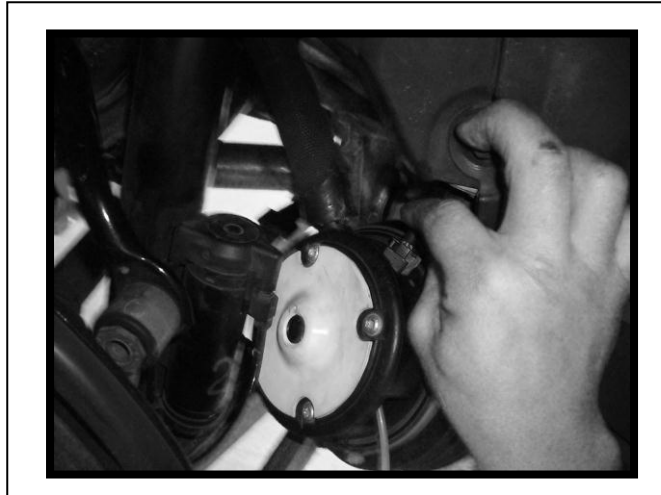

FIGURE 10-2

6.0 REMOVE AIR SPRING BOLTS FROM THE LOWER CONTROL ARM.
(FIGURE 10-3)



FIGURE 10-3



7.0 REMOVE OLD AIR SPRING. (FIGURE 10-4)



FIGURE 10-4

8.0 REPLACE RETENTION CLIP WITH NEW CLIP PROVIDED ON THE UPPER MOUNT. (FIGURE 10-5)

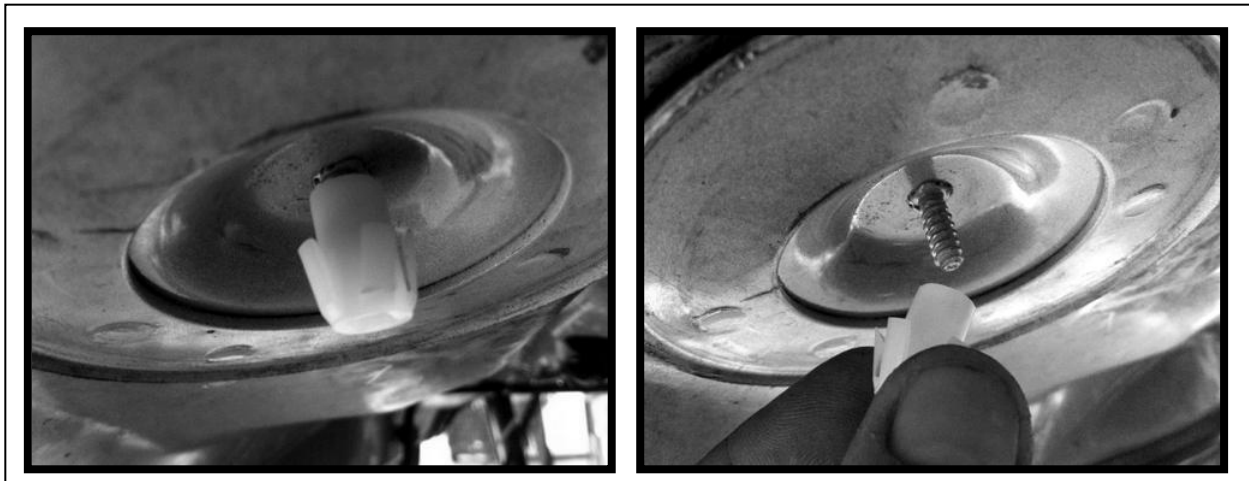

FIGURE 10-5



9.0 WITH THE AIR SPRING REMOVED FROM THE VEHICLE, REMOVE THE AIR LINE FROM AIR SPRING. (FIGURE 10-6)



FIGURE 10-6

PREPARATION OF AIR SPRING

1.0 REMOVE FOUR SCREWS AND TOP CAP. (FIGURE 10-7)



FUGURE 10-7



2.0 REMOVE SOLENOID AND O-RINGS. (FIGURE 10-8)

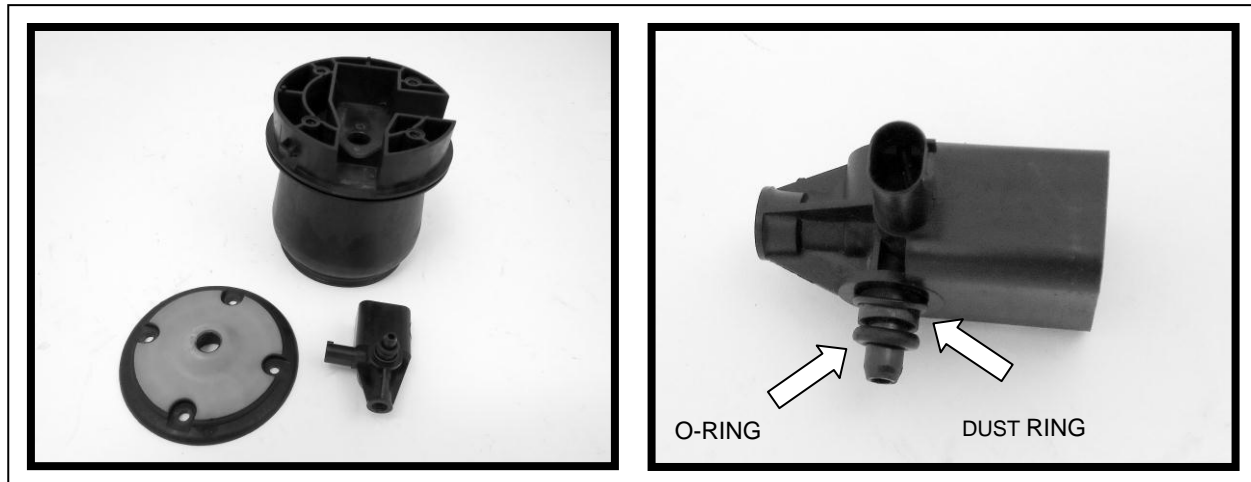

FIGURE 10-8

3.0 INSTALL SOLENOID IN NEW TOP MOUNT, AND REINSTALL CAP WITH PROVIDED FASTENERS. (FIGURE 10-9)

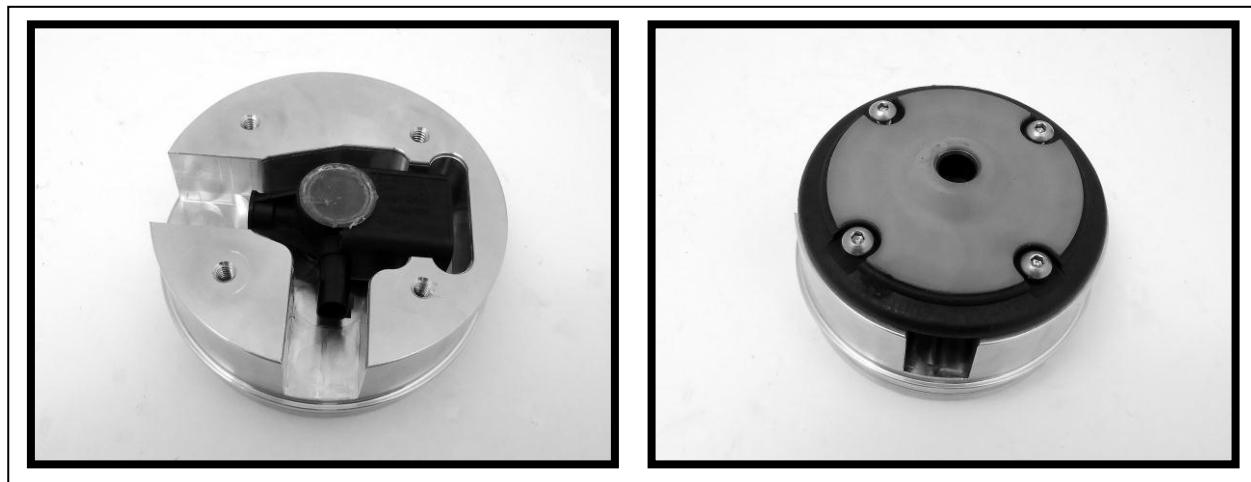



FIGURE 10-9



REAR SPRING INSTALLATION:

 ***Torque nuts and bolts to the manufactures specification.***

1.0 ALIGN LOGO AND AIR FITTING OUTBOARD, TOWARDS WHEEL (FIGURE 10-10)



FIGURE 10-10

2.0 COMPRESS AIR SPRING TO INSTALL. (FIGURE 10-11)

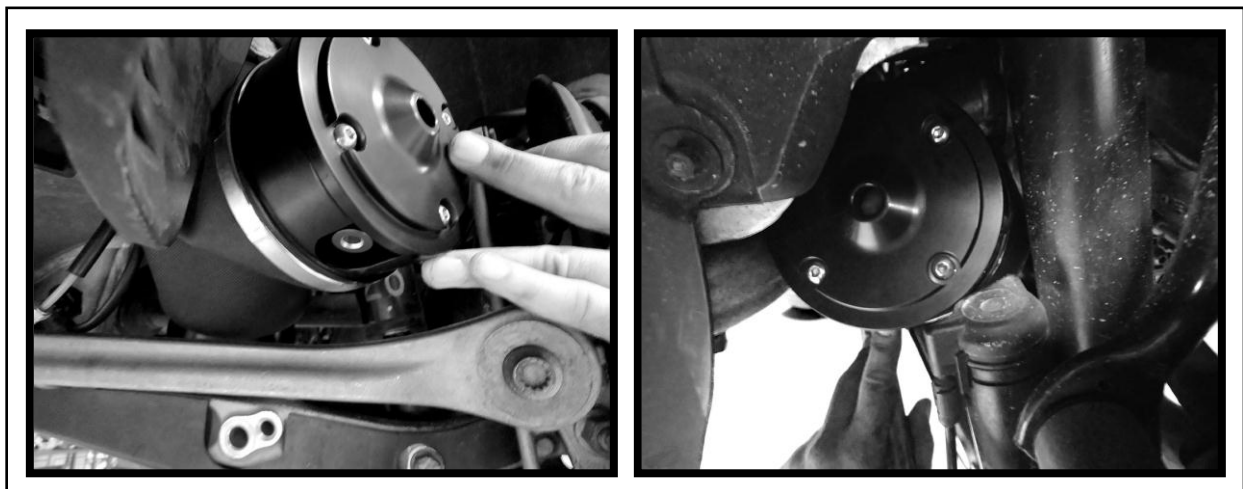

FIGURE 10-11



3.0 LINE UP MOUNT TO LOWER CONTROL ARM. (FIGURE 10-12)



FIGURE 10-12

4.0 INSTALL, AND TIGHTEN MOUNTING BOLT. (FIGURE 10-13)

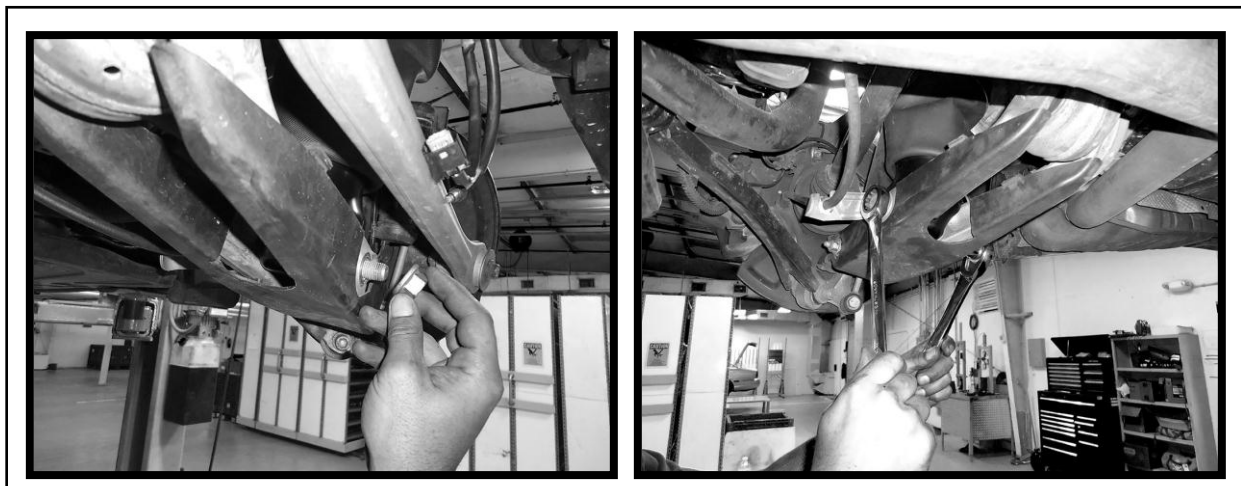

FIGURE 10-13



5.0 ENGAGE TOP CLIP, AND INSTALL AIR LINE. (FIGURE 10-14)

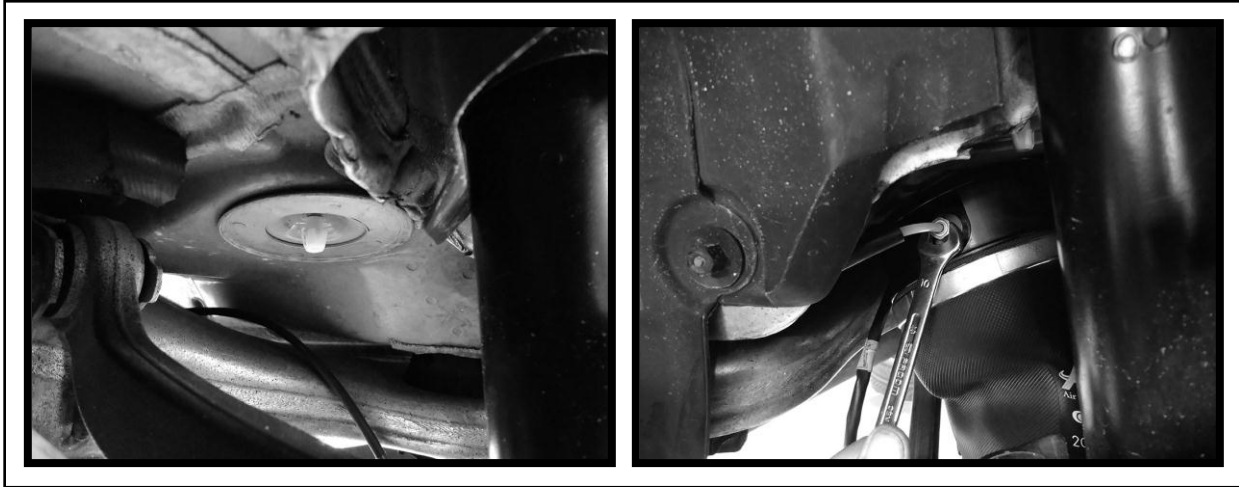

FIGURE 10-14

6.0 CONNECT AIR SPRING VALVE WIRING. (FIGURE 10-15)



FIGURE 10-15



- 7.0 INSTALL REAR TIRE; TIGHTEN LUG NUTS TO MANUFACTURERS' SPECIFICATION.
- 8.0 LOWER VEHICLE TO STANDARD VEHICLE HEIGHT FROM THE LIFTING PLATFORM.
- 10.0 RE-CONNECT POSITIVE BATTERY TERMINAL.



Never under any circumstances allow the vehicle to be fully lowered from the lifting platform (hoist) with the air suspension depressurized.

- 11.0 START ENGINE, WAIT 2 MINUTES, OPERATE THE RAISING FUNCTION OF THE CARS ELECTRONICS.
- 12.0 INITIALLY LOWER LIFTING PLATFORM SLOWLY AND ONLY COMPLETELY WHEN THE VEHICLE RISES OF ITS OWN ACCORD.
- 13.0 CHECK SHOCK FOR LEAKS.
- 14.0 INSTALLATION COMPLETE.



VERY IMPORTANT!!

THESE AIR SPRINGS CONTAINS A SOLENOID VALVE. ONCE INFLATED; ONLY THE "MERCEDES DAS STAR" DIAGNOSTIC COMPUTER CAN DEFLATE THE AIR SPRINGS.