



KIT NUMBER A-2465

2000-2006 BMW X5 LEFT FRONT SHOCK RE-BUILD KIT INSTRUCTIONS

Congratulations on your selection to purchase an Arnott Air Suspension System. We at Arnott Air Suspension Systems are proud to offer a high quality product at the industries most competitive pricing. Thank you for your confidence in us and our product.

Proper installation is essential to experience and appreciate the benefits of this system. Please take a moment to review these installation instructions before you begin to install this system on your vehicle.

It is equally important to be aware of all necessary safety measures while installing your new Air Ride System. This includes proper lifting and immobilizing of the vehicle and isolation of any stored energy to prevent personal injury or property damage.

“Engineered to Ride, Built to last”



WARNING: *The air suspension system is under pressure (up to 10 bar, or 150 lbf/in) verify pressure has been relieved and disconnect power to the air ride system prior to disassembly. Do not allow dirt or grease to enter the system. Always wear standard protective hand, ear, and eye protection when servicing the air suspension system.*

Kit contains:

PARTS LIST		
P/N	QTY	DESCRIPTION
A-2465	1	LEFT AIR SLEEVE ASSEMBLY
20-4089	1	TOP SEALING WASHER

ENCLOSED IS A RETURN SHIPPING LABEL, WE ASK THAT YOU PLEASE PUT THE “**DISCARDED**” PARTS IN THE SHIPPING BOX AND SEND BACK TO “ARNOTT AIR SUSPENSION SYSTEMS” AND WE WILL DISPOSE OF THE PARTS IN THE PROPER MANNER. WE TOO ARE TRYING TO LESSEN THE IMPACT ON THE ENVIRONMENT.

General information:

**Avoid damage to air lines and cables.*

**Removal and installation is only to be performed by full qualified personnel.*

**CAUTION: Damage to the vehicle and shock assembly can be incurred if work is carried out in a manner other than specified in the instructions or in a different sequence.*



KIT NUMBER A-2465

2000-2006 BMW X5 LEFT FRONT SHOCK RE-BUILD KIT INSTRUCTIONS

SHOCK REMOVAL:



The ignition must remain switched off during the shock removal and replacement.

- 1.0 Set steering to straight ahead.
- 2.0 Locate and remove the air compressor fuse.



Use lifting platform (hoist) that is capable of raising the body separately from the wheels, lift body at the lifting points prescribed by the vehicle manufacturer.

Vehicle slippage can cause danger to life and limb.

- 3.0 Raise vehicle.
- 4.0 Remove front tire.
- 5.0 Remove shock assembly per manufactures instructions (retain lower shock mounting hardware for re-installation) (Figure A).



Figure A



KIT NUMBER A-2465

2000-2006 BMW X5 LEFT FRONT SHOCK RE-BUILD KIT INSTRUCTIONS

SHOCK DISASSEMBLY/ASSEMBLY:

- 1.0 Remove the M14x1.5mm lock-nut, top sealing washer and top washer from the top of the shock, discard top sealing washer (Figure B).

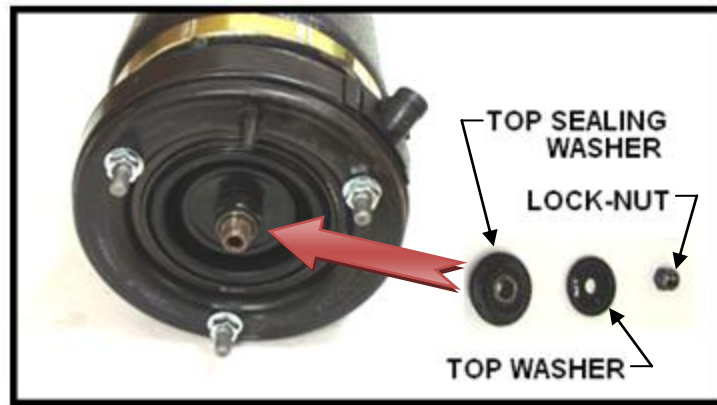

Figure B

- 2.0 Remove the plastic retaining pin at the bottom of the air sleeve assembly and discard (Figure C).

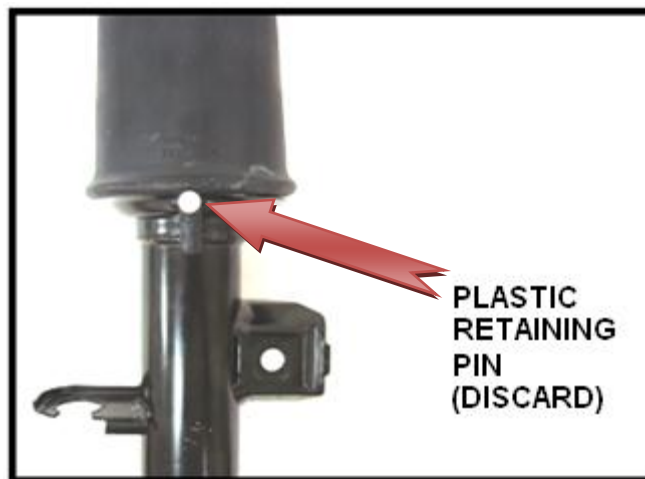

Figure C



KIT NUMBER A-2465

**2000-2006 BMW X5 LEFT FRONT
SHOCK RE-BUILD KIT INSTRUCTIONS**

3.0 Remove the air sleeve assembly from the shock and discard (Figure D).

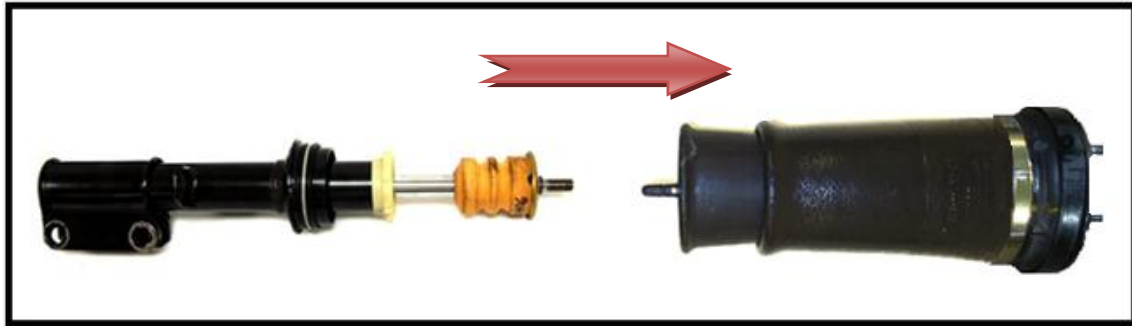

Figure D

4.0 Remove the two (2) o-rings and two (2) back-up rings from the shock and discard. (Figure E).

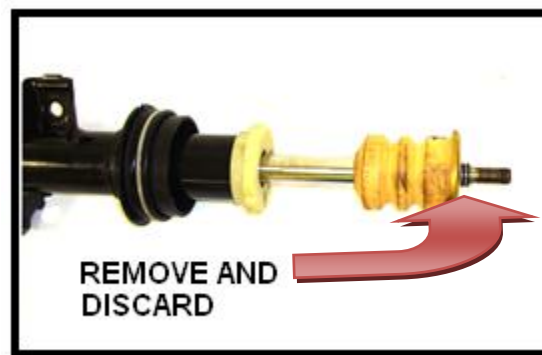

Figure E

PLEASE PUT THE “DISCARDED” PARTS IN THE SHIPPING BOX AND SEND BACK TO “ARNOTT AIR SUSPENSION SYSTEMS”.

5.0 Install the new “ARNOTT” air sleeve assembly onto shock; apply a silicone base lubricant on the lower o-rings prior to installing air sleeve assembly (Figure F).

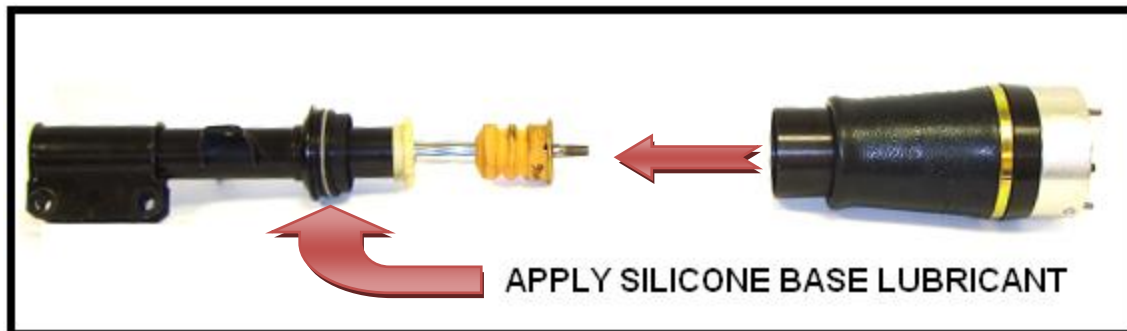

Figure F



KIT NUMBER A-2465

**2000-2006 BMW X5 LEFT FRONT
SHOCK RE-BUILD KIT INSTRUCTIONS**

- 6.0 Press air sleeve assembly down until lower piston is over the 2 (two) lower o-rings (failure to do this will cause the air sleeve assembly not to seal and will not inflate (Figure G).



Figure G

CAUTION: WHEN INSTALLING THE TOP SEALING WASHER MAKE SURE THAT THE LIP ON THE INSIDE DIAMETER (SMALLER) IS FACING OUT. IMPROPER INSTALLATION CAN CAUSE DAMAGE TO THE SHOCK ASSEMBLY AND VOID WARRANTY.

- 7.0 Install top sealing washer, top washer and lock-nut, torque lock-nut to 55-60 LB-FT (75-80 Nm) (Figure H).

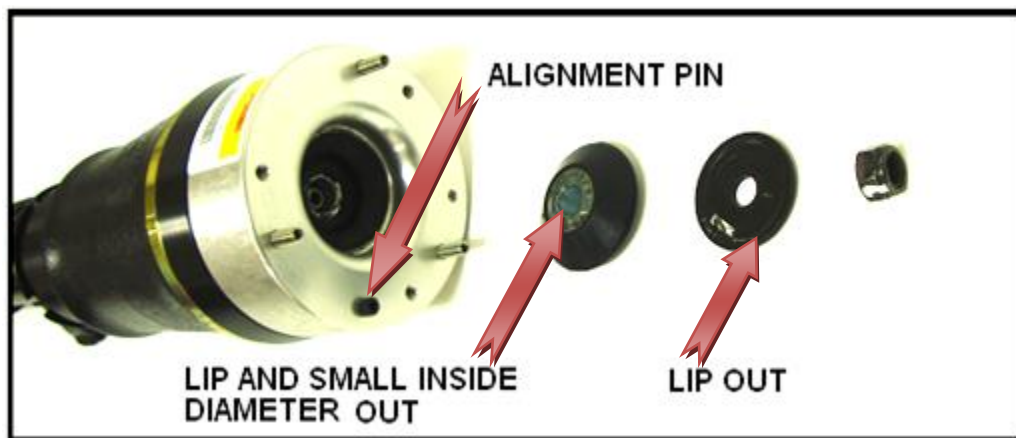

Figure H

- 8.0 Disassembly/assembly complete.



KIT NUMBER A-2465

2000-2006 BMW X5 LEFT FRONT SHOCK RE-BUILD KIT INSTRUCTIONS

SHOCK INSTALLATION:

- 1.0 Remove the 3 (three) nuts on the top mount of the shock assembly.
- 2.0 Install the new shock assembly into the upper and lower shock mounts.
- 3.0 Tighten the top 3 (three) nuts and the lower 2 (two) bolts/nuts to the manufacturers' specification.
- 4.0 Connect air supply line, tighten to 17.7 IN/LBS (2 Nm).
- 5.0 Install tire, tighten lug nuts to manufacturers' specification.



Never under any circumstances allow the vehicle to be fully lowered from the lifting platform (hoist) with the air suspension depressurized.

- 6.0 Re-install the air compressor fuse.
- 7.0 Lower vehicle to standard vehicle height from the lifting platform.
- 8.0 Start engine, wait 2 minutes, operate the raising function of the cars electronics.
- 9.0 Initially lower lifting platform slowly and only completely when the vehicle raises of its own accord.
- 10.0 Check shock for leaks.
- 11.0 Installation complete.